

# Hexagon Connection Nuts

## DIN 6334

Hexagon Connection Nut

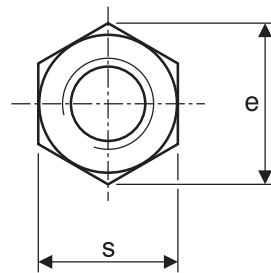
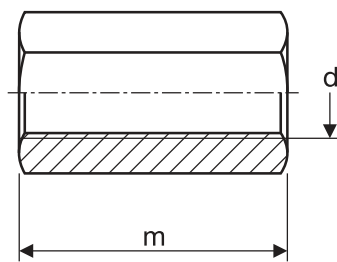

Bolt Extension

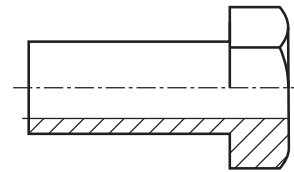

### DIN 6334 Dimensions of nuts

Nominal size and thread diameter d	Pitch of thread p	Width across flats s	Width across corners e	Overall length m
	coarse pitch	min.	min.	min.
M6	1.00	10.00	11.05	18.00
M8	1.25	13.00	14.38	24.00
M10	1.50	17.00	18.90	30.00
M12	1.75	19.00	21.10	36.00
M14	2.00	22.00	24.49	42.00
M16	2.00	24.00	26.75	48.00
M18	2.50	27.00	29.56	54.00
M20	2.50	30.00	33.53	60.00
M22	2.50	32.00	35.03	66.00
M24	3.00	36.00	41.60	72.00
M27	3.00	41.00	45.20	81.00
M30	3.50	46.00	50.85	90.00
M33	3.50	50.00	55.37	99.00
M36	4.00	55.00	60.79	108.00

Hexagon Connectors, also commonly known as Studding Connectors or Couplers, are predominantly used as a method of extending tie-rods and allthread bars. The rule concerning their installation is simply that 50% of the connector should be engaged on each part being joined to ensure the tensile strength is maintained.

Most connectors are manufactured from mild steel hexagon bar, in some cases round bars, being drilled and tapped 100% of its length internally. Whilst it is advised to seek a higher strength material grade when applications involve the extension or connection of 8.8 grades and higher, independent tests have been performed to ensure compatibility with use on higher grades including 8.8.

All of our standard range of connectors will be supplied as Grade 8 or will be advised that they are compatible for use up to 8.8 grades. We stock a comprehensive range of metric sizes up to M36 with sizes M39 and above manufactured to order with a few days lead time.

#### Available Grades

All available in self-colour, zinc plated, and galvanized tapped oversize from stock. Other finishes and materials are available on request.

Bolt Extensions are also available, but supplied as a headed hexagon blank, drilled and tapped internally. Dimensions not shown.