

Flat Countersunk Square Neck Bolts (Plow Bolts)

DIN 605 Long Square Version

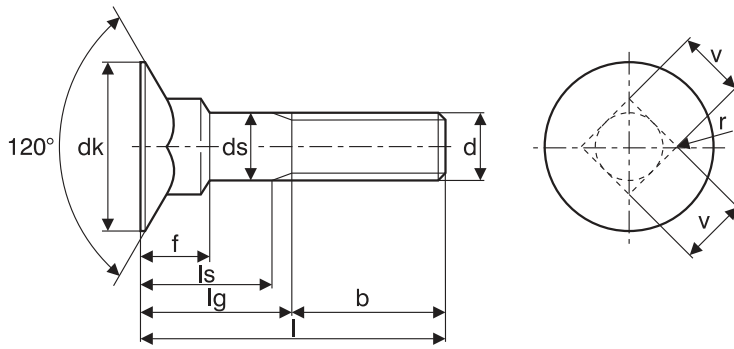

DIN605 Dimensions of bolts

Nominal size and thread diameter d	Pitch of thread P	Thread Length b			Diameter of countersunk head dk		Diameter of unthreaded shank ds ¹		Head thickness including square neck f		Radius r ²	With across square neck v	
		Bolt ≤125	Bolt 125-200	Bolt ≥200	max.	min.	max.	min.	max.	min.		max.	min.
M6	1.00	18	24	-	16.55	15.45	6	5.52	7.45	6.55	0.9	6.48	5.52
M8	1.25	22	28	41	20.65	19.35	8	7.42	9.45	8.55	1.2	8.58	7.42
M10	1.50	26	32	45	24.65	23.35	10	9.42	11.55	9.45	1.5	10.58	9.42

Nominal size	d		M6		M8		M10	
	l min.	l max.	ls min.	lg max.	ls min.	lg max.	ls min.	lg max.
30	28.95	31.05	-	12.5	-	16	-	-
35	33.75	36.25	-	12.5	-	16	-	-
40	38.75	41.25	17	22	-	16	-	18
45	43.75	46.25	22	27	16.75	23	-	18
50	48.75	51.25	27	32	21.75	28	16.5	24
55	53.50	56.50	32	37	26.75	33	21.5	29
60	58.50	61.50	37	42	31.75	38	26.5	34
65	63.50	66.50			36.75	43	31.5	39
70	68.50	71.50			41.75	48	36.5	44
80	78.50	81.50			51.75	58	46.5	54
90	88.75	91.75					56.5	64
100	98.25	101.75					66.5	74

Lengths exceeding 100mm must be graded by steps of 10mm. Intermediate lengths should be avoided wherever possible.

1) For manufacturing reasons the + IT 15 tolerance is permissible for a length of 2 d below head (including square). Therefore, the corresponding limiting dimension is given for v max. The shank diameter may also be pitch diameter at manufacturer's discretion.

2) Radius r must be adhered to for a minimum length of 0.5 the square length below the head.

Specification for bolts and reference standards

Characteristic	Standard	
Material	Steel	
General requirements	according to DIN267 Part 1	
Thread	Tolerance	8g
	Standard	DIN 13 Part 13
Mechanical Properties	Strength category ¹	3.6 or 4.6 at manufacturer's discretion
	Standard	DIN ISO 898 Part 1
Permissible dimensional deviations	Product grade	C (previous type g)
	Standard	DIN ISO 4759 Part 1
Surface	DIN 267 Part 2 applies to the peak-to-valley heights of surfaces.	
	Permissible surface defects according to DIN 267 Part 19.	
	Galvanic surface protection according to DIN 267 Part 9.	
	Hot-dip galvanising according to DIN 267 Part 10.	
Acceptance testing	according to DIN 267 Part 5	

¹ If a specific strength category is required this must be indicated in the designation e.g.: FLAT COUNTERSUNK BOLT DIN608 - M10 X 50 - 4.6
Other strength categories only on agreement.