

Cotter pins

Cotter pins are stocked in diameters 1mm to 13mm in mild steel (usually zinc plated), 1mm to 6.3mm in stainless steel A4 and brass.

Our specifications follow DIN 94, which is equivalent to ISO 1234 and BS 1574. Due to the loose fit required for cotter pins, the metric range doubles for inch sizes.

MATERIALS

MILD STEEL, ZINC PLATED

STAINLESS A4

BRASS

STANDARDS

DIN 94 (stocked)

BS 1574

BS 7724

ISO 1234

SIZE RANGE – COTTER PINS

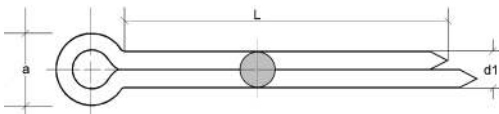

Nominal Diameter, Cotter Pins	1	1.2	1.6	2	2.5	3.2	4	5	6.3	8	10	13
Available Materials	Mild Steel, Zinc Plated Stainless Steel Brass										Mild Steel, Zinc Plated Only	
Dimension 'd1'	Max 0.9	1.0	1.4	1.8	2.3	2.9	3.7	4.6	5.9	7.5	9.5	12.4
	Min 0.8	1.09	1.3	1.7	2.1	2.7	3.5	4.4	5.7	7.3	9.3	12.1
Dimension 'a'	Max 1.8	2.0	2.8	3.6	4.6	5.8	7.4	9.2	11.8	15.0	19.0	24.8
	Min 1.6	1.7	2.4	3.2	4.0	5.1	6.5	8.0	10.3	13.1	16.6	21.7
Lengths in mm												
6												
8												
10												
12												
16												
18												
20												
22												
25												
28												
32												
36												
40												
45												
50												
56												
63												
71												
80												
90												
100												
112												
125												
140												
160												